

Maximum Average Pressure (MAP)* = 52,000 psi

Instrumental Velocity: 100-gr @ 1,250 fps

Crusher pressure limits not established.

115-gr @ 1,150 fps

* Refer to SAAMI Z299.3 for pressure guideline interpretation description.

MAXIMUM CARTRIDGE / MINIMUM CHAMBER

ISSUED: 06/07/2022

30 SUPER CARRY (30 S CARRY)

REVISED: - / - / - - -

Note - The User's attention is called to the fact that an assurance has been provided by a person claiming to own intellectual property rights that will be necessarily infringed by use of this Standard, and that such person is prepared to grant non-exclusive licenses in connection with such intellectual property rights on reasonable terms and conditions, which may be royalty bearing or royalty free as shall be negotiated, and free of any demonstrably unfair discrimination. Further information may be obtained from SAAMI's Technical Office.

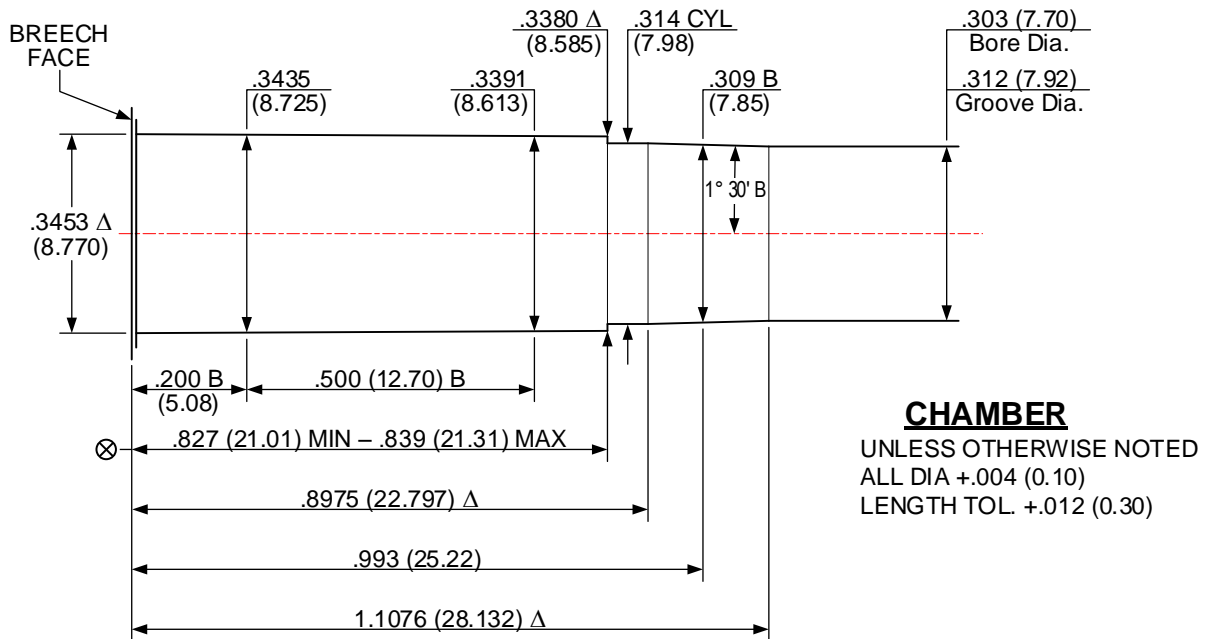
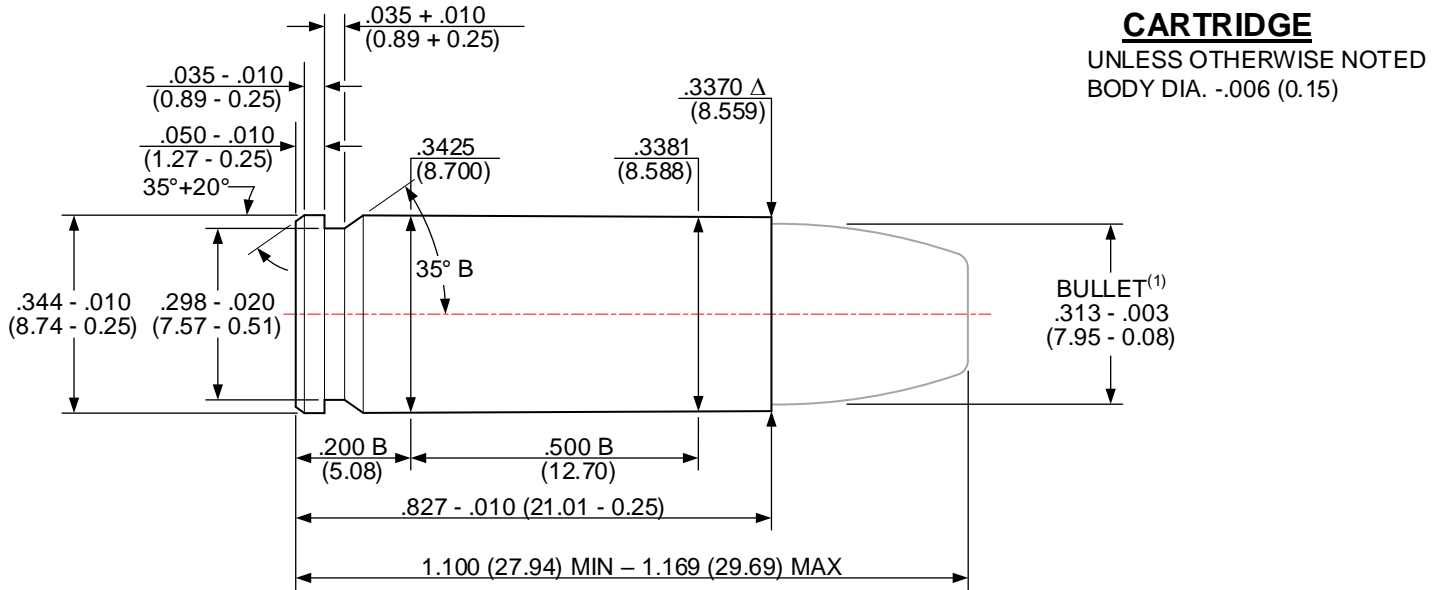

Δ 5 GROOVES

TWIST: 10.00 (254.0) R.H. OPTIONAL

Δ .095 + .002 (2.41 + 0.05) WIDE MINIMUM BORE & GROOVE AREA: .0742 inch² (47.870 mm²)

NOTE:

B = BASIC

(XX.XX) = MILLIMETERS

⊗ = HEAD SPACE DIMENSION

Δ = REFERENCE DIMENSION

* = DIMENSIONS ARE TO INTERSECTION OF LINES

ALL CALCULATIONS APPLY AT MAXIMUM MATERIAL CONDITION (MMC)

(1) - BULLET PROFILE IS SHOWN FOR ILLUSTRATIVE PURPOSES ONLY

DO NOT SCALE FROM DRAWING

VELOCITY & PRESSURE TEST BARREL

30 SUPER CARRY (30 S CARRY)

V&P TEST BARREL

ISSUED: 06/07/2022

REVISED: -/-/-/-

Note - The User's attention is called to the fact that an assurance has been provided by a person claiming to own intellectual property rights that will be necessarily infringed by use of this Standard, and that such person is prepared to grant non-exclusive licenses in connection with such intellectual property rights on reasonable terms and conditions, which may be royalty bearing or royalty free as shall be negotiated, and free of any demonstrably unfair discrimination. Further information may be obtained from SAAMI's Technical Office.

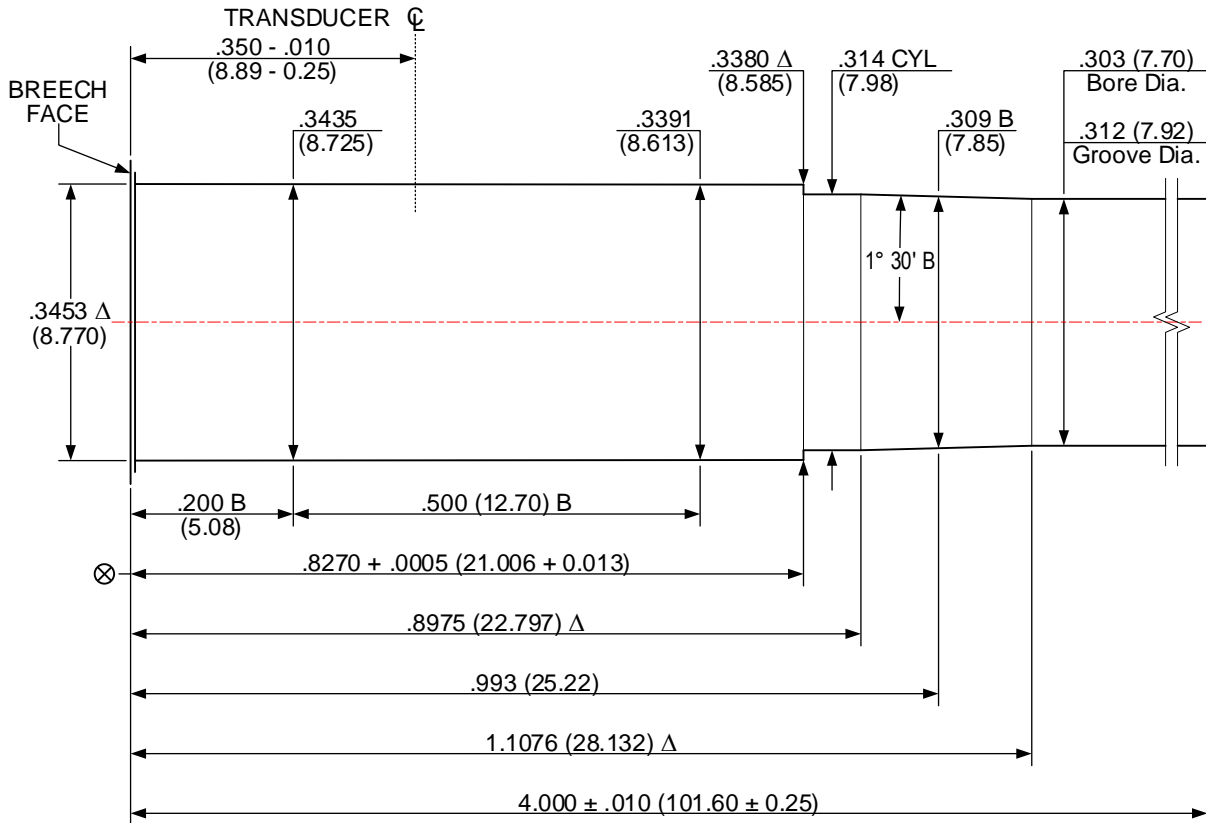

DO NOT SCALE FROM DRAWING

- NUMBER OF GROOVES: 5
- WIDTH OF GROOVES: .095 + .002 (2.41 + 0.05)
- TWIST RATE: 10.00 (254.0) R.H.
- DIAMETER OF PISTON HOLE: .Crusher pressures not established
- TRANSDUCER DIAMETER: .250 (6.35)

LAND AND GROOVE DIMENSIONS TO BE WITHIN TOLERANCES THROUGHOUT LENGTH OF BARREL.

UNLESS OTHERWISE NOTED, ALL DIAMETERS +.0005 (0.013) LENGTH TOLERANCE + .005 (0.13)

NOTE:

- B = BASIC
- Δ = REFERENCE DIMENSION
- ⊗ = HEADSPACE DIMENSION
- * DIMENSIONS ARE TO INTERSECTIONS OF LINES
- (XX.XX) = MILLIMETERS
- ALL CALCULATIONS APPLY AT MAXIMUM MATERIAL CONDITION (MMC)

Support products supplier:

Federal Cartridge Company
 Brenda Andersonph. 208-750-3142..... email: Brenda.anderson@vistaoutdoor.com
 Jake Cahillph. 208-750-3160 email: Jake.cahill@vistaoutdoor.com

Order symbols/part numbers:

Reference rounds: SAMAE30SCA Dummy rounds: 30SCDUMMY Proof ammunition: 30SCPRF