

# SAAMI New Cartridge & Chamber

Maximum Average Pressure (MAP)\* = 46,000 psi  
 Crusher pressures not established.

Instrumental Velocity\*\*: 240-gr @ 1,720 fps  
 (\*\* - Based on a 6" SAAMI-compliant test barrel)

\* Refer to American National Standard SAAMI Z299.3 for pressure guideline interpretation description.

ISSUED: 01/19/2021

## 429 DESERT EAGLE [429 DE]

REVISED: -/-/-/-

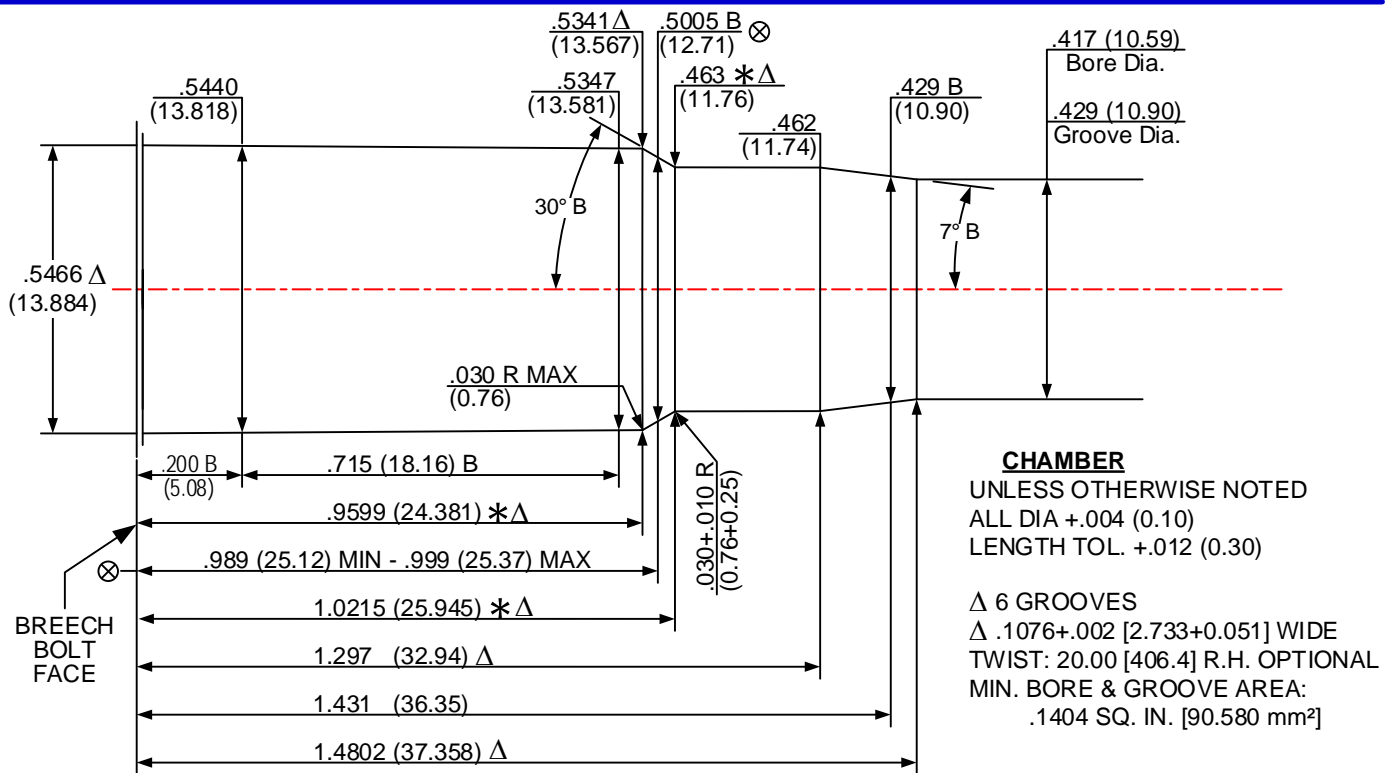
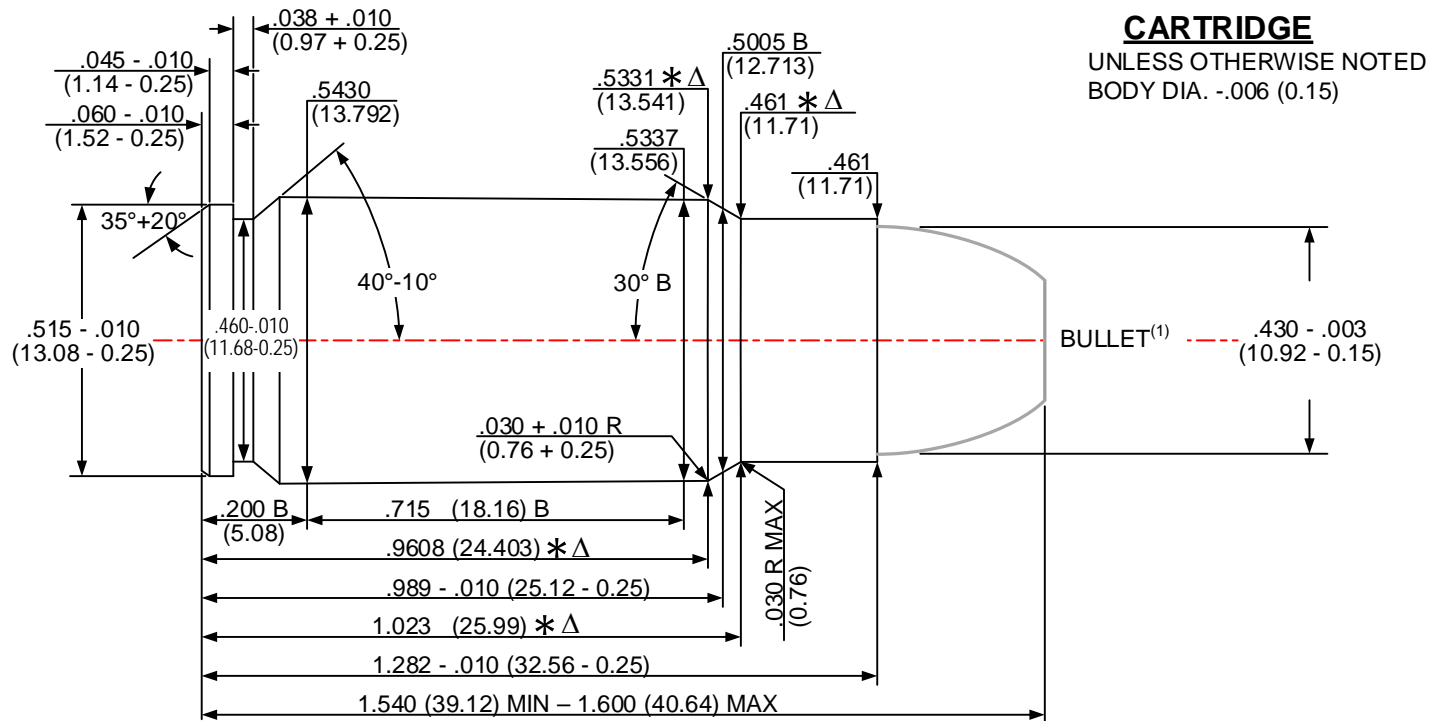

**DO NOT SCALE FROM DRAWING**

**NOTE:**

- B = BASIC
- Δ = REFERENCE DIMENSION
- ALL CALCULATIONS APPLY AT MAXIMUM MATERIAL CONDITION (MMC)
- (1) - BULLET PROFILE IS SHOWN FOR ILLUSTRATIVE PURPOSES ONLY
- (XX.XX) = MILLIMETERS
- \* = DIMENSIONS ARE TO INTERSECTION OF LINES

⊗ = HEAD SPACE DIMENSION

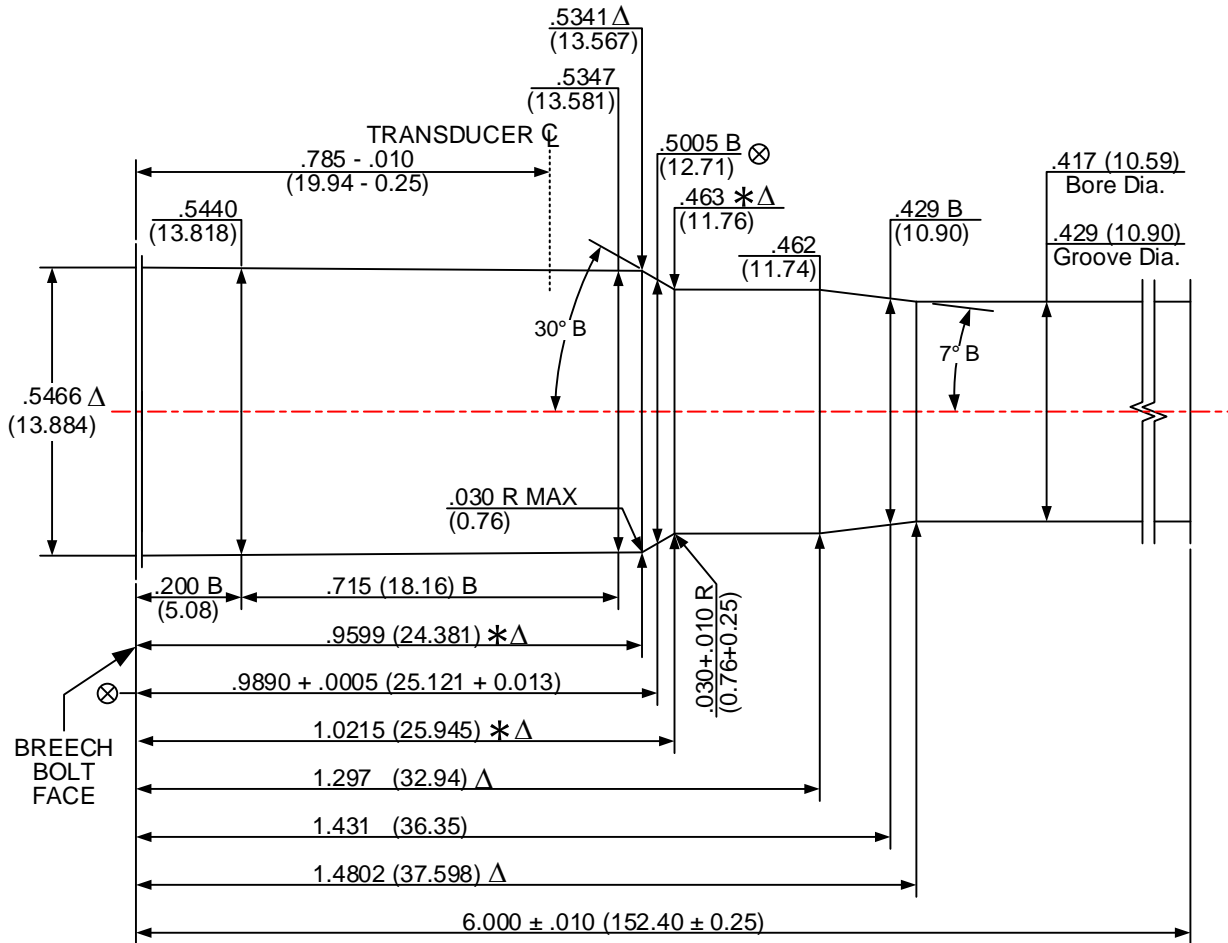

**DO NOT SCALE FROM DRAWING**

- NUMBER OF GROOVES: 6
- WIDTH OF GROOVES: .1076 + .0020 (2.733 + 0.051)
- TWIST RATE: 20.00 (508.0) RH
- DIAMETER OF PISTON HOLE: Crusher pressures not established
- TRANSDUCER DIAMETER: .250 (6.35)

LAND AND GROOVE DIMENSIONS TO BE WITHIN TOLERANCES THROUGHOUT LENGTH OF BARREL.

UNLESS OTHERWISE NOTED, ALL DIAMETERS +.0005 (0.013) LENGTH TOLERANCE + .005 (0.13)

**NOTE:**

- B = BASIC
- Δ = REFERENCE DIMENSION
- ⊗ = HEADSPACE DIMENSION
- \* DIMENSIONS ARE TO INTERSECTIONS OF LINES
- (XX.XX) = MILLIMETERS
- ALL CALCULATIONS APPLY AT MAXIMUM MATERIAL CONDITION (MMC)